

EAL Pre-Session: Saturday, July 9th **The Art of Kansas City**



Join us **Saturday, July 9th** for special tours in The Nelson-Atkins Museum of Art, led by KCAI's Art History faculty, Jan Kennedy and Rebecca Dubay. We will have a catered lunch on KCAI's campus and meet in Kansas City's Crossroads Arts District for gallery tours.

♦ The \$150 fee also includes optional housing on Friday & Saturday nights, as well as meal options in Wylie Dining on Friday, Saturday and Sunday.

- ▶ Friday, July 8th: Dinner (6:00 p.m. - 7:00 p.m.)
- ▶ Saturday, July 9th: Breakfast (7:00 a.m. - 8:00 a.m.), Dinner (6:00 p.m. - 7:00 p.m.)
- ▶ Sunday, July 10th: Breakfast (9:00 a.m. - 10:00 a.m.), Lunch (1:00 p.m. - 2:00 p.m.)

Pre-Session Schedule

7 a.m. - 8 a.m. Breakfast at Wylie Dining (optional)

9:45 a.m. Meet in the Barbara Marshall Residence Hall lobby and walk over to the Bloch Entrance at The Nelson-Atkins Museum of Art
(Optional: Meet at the large golden doors inside the Bloch Entrance)

10 - 11:30 a.m. Tours at The Nelson-Atkins Museum of Art

11:45 a.m. - 1 p.m. Catered lunch in Paul and Linda DeBruce Hall with KCAI faculty

2 - 3:30 p.m. Meet at Belger Arts Center for tour (2100 Walnut St, Kansas City, MO 64108; about a 10 minute drive)

** Participants are required to provide their own transportation and are welcome to carpool. Estimated Uber/Lyft cost: \$10.*

3:30 p.m. Free time in Crossroads Arts District

- *We invite you to explore Kansas City's vibrant community. Check out our list of staff favorite restaurants, galleries, museums and other great gems!*
- *An optional dinner will be offered in Wylie Dining from 6:00 p.m. - 7:00 p.m.*



JAN KENNEDY, PH.D.

Associate Professor, Program Head of the Art History and Asian Studies Programs

Jan Kennedy joined the faculty at KCAI in 2006, previously working as a lecturer at KCAI and adjunct assistant professor at Washburn University in Topeka, Kan. She received a B.A. in the history of art and English literature, an M.A. in the history of art, and a Ph.D., all from the University of Kansas. Her major area for her Ph.D. was 17th Century Dutch and Flemish paintings and prints, and her minor areas were Venetian Cinquecento painting and Japanese painting of the Edo period. More recently, she was a keynote speaker presenting her current area of research on the Christian art of Japan. Kennedy is a member of the College Art Association, the Historians of Netherlandish Art and the Association for Asian Studies.



REBECCA DUBAY, PH.D.

Associate Professor and Ray Beagle Chair of Art History

Rebecca Dubay, associate professor and Ray Beagle Chair of art history, specializes in art from 1945 to the present. Her research interests include art of the 1960s, the politics of abstraction, gender studies, and migration. Dubay has presented her research at conferences in London, Frankfurt am Main, Nijmegen, and Washington DC, among other cities. In 2018, she was honored with KCAI's Excellence in Teaching Award. Before joining KCAI, Dubay taught in the M.F.A. in studio art program at Moore College of Art and Design. She earned a B.A. degree in art history and business management from the University of South Florida, an M.A. degree in art history from Tufts University, and M.A. and Ph.D. degrees in the history of art from Bryn Mawr College.



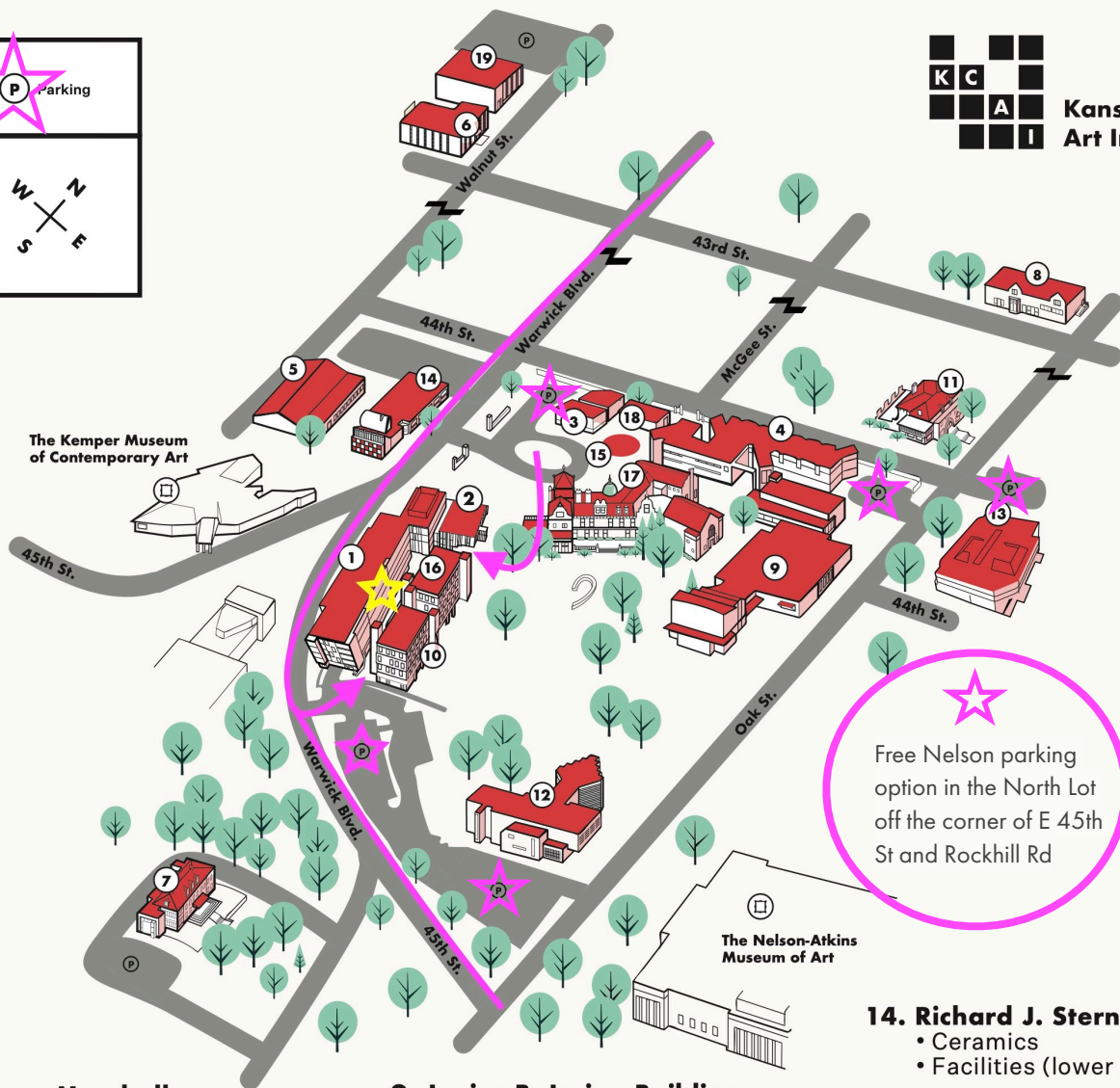

19. The Warehouse

- Fiber